

• TRUSTED QUALITY SINCE 1921 •  
**RUST-OLEUM®**  
**Cabinet**  
Transformations®

Instructional Pamphlet



11 Hawthorn Pkwy, Vernon Hills, IL 60061  
800-323-3584 [rustoleum.com/transformations](https://rustoleum.com/transformations)

• TRUSTED QUALITY SINCE 1921 •  
**RUST-OLEUM®**  
**Cabinet**  
**Transformations®**

How to Apply Cabinet Transformations®  
**Rust-Oleum® Cabinet Transformations® is a revolutionary do-it-yourself cabinet coating system that enables you to easily and affordably transform your cabinets from an outdated look to a beautiful and durable new finish.**

**IMPORTANT:** These instructions include several important information boxes with critical, how-to information necessary to ensure the best product application process and highest quality results. Read in its entirety before beginning the project.

## GATHER YOUR TOOLS AND SUPPLIES

Collect supplies needed for your project using the Project Supplies Checklist below.

---

### PROJECT SUPPLIES CHECKLIST

---

#### INCLUDED IN KIT

##### Cabinet Transformations Coating System

- Krud Kutter® Cleaner/Degreaser
- Bond Coat\*
- Protective Top Coat

#### NOT INCLUDED IN KIT

##### Other Items Needed:

- 2" synthetic paint brushes
- ¼" nap synthetic roller covers and handles
- Smooth Painter's Tape
- Drop cloths
- Disposable gloves
- Lint-free rags
- Disposable paint trays/containers

#### Suggested Items Needed:

- Screwdriver or cordless drill/driver
- Wood filler and putty knife (if filling hardware holes)
- Plastic door/drawer bumpers

---

**\* Deep Base and Midtone Base bond coat must be tinted in-store prior to application**

## HOW TO MEASURE SQUARE FOOTAGE

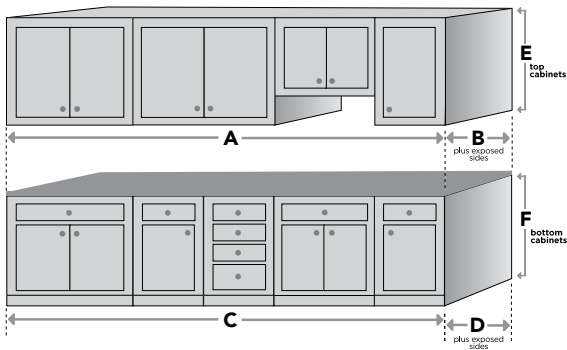

### Square Feet – Calculate your exact coverage needs

- STEP 1:** Measure the length of your top cabinets (A + B) in inches and multiply by the height (E). Standard wall cabinet heights are: 12" – 18" and 30" – 42".
- STEP 2:** Measure the length of your bottom cabinets in inches (C + D) and multiply times the height (F). Standard base cabinet height is: 34-1/2".
- STEP 3:** Add these two totals together and divide by 144 to determine the total square feet you will need to cover.

Visit [rustoleum.com/transformations](http://rustoleum.com/transformations) to use our online calculator.

**IMPORTANT:** Properly measure your cabinetry prior to starting the project. If these measurements exceed the coverage on your kit package, you will need to purchase an additional kit.

## PREPARE FOR THE PROJECT

For best results take cabinet doors off hinges and drawers out of frames. Remove all cabinet hardware, including hinges, drawer pulls, and knobs. Laying cabinet doors and drawers on a flat, horizontal surface while coating will ensure the easiest application and best outcome. Create an assembly line of cabinet doors and drawers to speed up the process.

### CLEAN ALL SURFACES

The Cabinet Transformations requires a clean, grease and wax free surface for proper adhesion. After removing all of the cabinet doors, drawers and hardware – proceed with a **THOROUGH** cleaning of all surfaces with the included Krud Kutter Cleaner/Degreaser.

1. Rinse or wipe away any loose dirt or dust.
2. Apply a liberal amount of the included cleaner/degreaser to the surfaces with a lint-free rag. Allow to sit and penetrate 3-5 minutes before wiping dry with the rag (do not allow Krud Kutter to dry on the surface before wiping).

**IMPORTANT:** Thoroughly inspect the cabinet surfaces for heavy grease or dirt. Pay special attention to areas around the stove, microwave and sink. Clean these extra dirty or greasy areas with soapy water and wipe clean prior to cleaning with Krud Kutter®.

## VERIFY SURFACE ADHESION

- Before coating all of the cabinet surfaces, bond coat application should be tested for proper adhesion. On a cleaned, 3" x 3" inconspicuous area of the project, apply bond coat. Allow to dry for 2 hours. Take a utility knife and make an X in the coating down to the cabinet surface. Apply your painter's tape over the X and press firmly. Remove the tape with one quick pull. If more than 10% of the coating comes off, the cabinet surfaces may have a wax finish and will need to be scuffed for lightly sanded to remove the wax prior to complete application of the bond coat. Remove any debris left from sanding/scuffing prior to bond coat application.

**IMPORTANT:** Failure to follow this preparation method may result in poor adhesion and possible coating failure.

### STEP #1 – APPLY BOND COAT

The bond coat is specially formulated to provide maximum adhesion to wood, laminate and melamine surfaces.

### START WITH CABINET FRAMES

- Tape off all edges and areas that you wish to keep free of paint – i.e. the inside edges of cabinet frames, the walls, counters and backsplashes.
- Thoroughly stir the bond coat and pour into a disposable tray/container. Starting with the cabinet frames, apply an even coat of bond coat – using a 2" brush for detailed areas and a ¼" nap roller for the broad, open areas.
- Use roller in up and down motion on the stiles and frame sides. Use roller with side-to-side motion on the rails (see diagram).
- Once the first coat is dry (approximately 2 hours), apply a second coat if needed. Allow second coat to dry 2 hours before moving on to the Top Coat step.

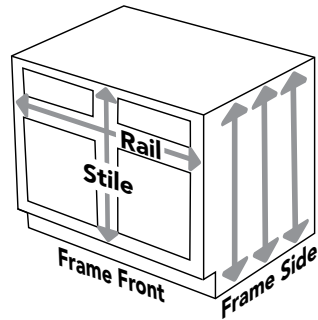

## CONTINUE WITH CABINET DOORS AND DRAWERS

1. For easier application purposes, use a prop to elevate the door off the worktable.
2. Begin with the BACK SIDE of each door. Use a 2" brush for detailed areas and a ¼" nap roller for the broad, open areas.

Use the following application method:

1. Apply Bond Coat to all four inside corners and sides
2. Coat center panel with long, smooth vertical strokes
3. Coat the top and bottom portions with long, horizontal strokes
4. Brush outer sides in a vertical motion

*Note: For flat panel doors use up-and-down vertical strokes. Use side-to-side horizontal strokes on drawers.*

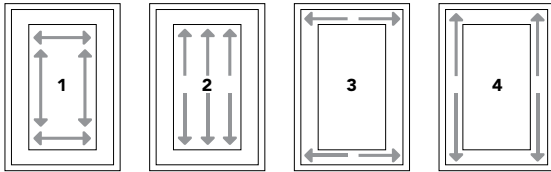

3. Look for excess bond coat in corners and crevasses and use the paint brush to remove build up. Let dry for 2 hours. After first coat is dry, using the same method, apply a second coat if needed.

## CONTINUE WITH CABINET DOORS AND DRAWERS

4. Continue to the FRONT SIDE of each door and drawer. When the back side of each door is fully coated and dried (approximately 2 hours), carefully turn the doors over. Apply two coats of bond coat to each door and drawer front using the same application process described in steps 1-3 on previous page. Be sure to coat the door and drawer edges when completing the fronts. Watch for drips.

Refer to [rustoleum.com/transformations](http://rustoleum.com/transformations) for instructions on using optional decorative glaze (sold separately).

### STEP #2: APPLY PROTECTIVE TOP COAT

The protective top coat is formulated to provide superior stain and scratch resistance and is required for full performance of the cabinet coating system.

1. Thoroughly stir the protective top coat.
2. Using a 2" brush for detailed areas and a ¼" nap roller for broad, open areas apply an even layer of protective top coat to the cabinet boxes and frames. As when you applied the bond coat - use vertical strokes on the cabinet sides and stiles and horizontal strokes on the rails. Once finished, inspect the surfaces and touch up any light areas where more protective top coat is needed.
3. Once the boxes and frames are complete, apply the protective top coat to the BACK SIDE of the doors/drawers first. Apply using the bond coat application method outline in Step #1. Only one coat of protective top coat is required. Allow 2 hours to dry.

## **STEP #2: APPLY PROTECTIVE TOP COAT – cont...**

1. Coat the FRONT SIDE of the doors/drawers just as you applied to the back sides. Avoid over brushing in previously coated areas. If build-up occurs in recessed areas, wipe them out using a clean, dry synthetic paint brush.
2. Allow the protective top coat to dry for 2 hours. Inspect the surfaces and touch up any areas that need more protective top coat.
3. Allow final coated surfaces to dry for 12 hours before re-installing your cabinet doors, drawers and hardware. Install new door bumpers to back of doors and drawers.
4. The protective top coat will cure completely within 7 days. Avoid cleaning until product has cured for at least 7 days.



## **FAQ & Cabinet Care Tips**

Visit [www.rustoleum.com/transformations](http://www.rustoleum.com/transformations)